



SMART FAIRY LIGHTS

Controller Manual

Package:
 1 * Fairy Lights With USB Controller
 1 * Remote Controller
 1 * Controller Manual

1

Remote Manual

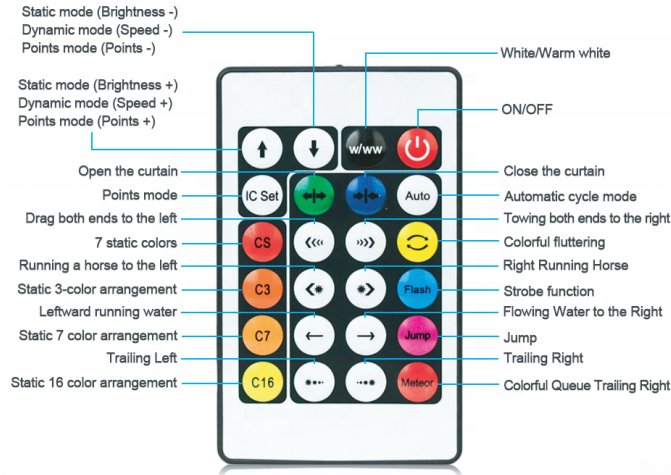

USB Controller

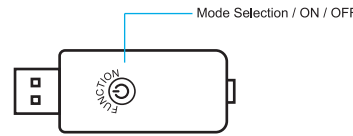

2

Download Application

Please search in major application markets "LotusLamp X" or scan the QR code below.



1. Scan the QR code on the controller manual to download "LotusLamp X", or search "LotusLamp X" in the iPhone app store or Google play store to download.
2. After the application is successfully downloaded, you need to open the Bluetooth function of your phone, then plug in the light bar, and then open the application, the application will automatically pair with the light bar, and then you can control the light.

*Android phones need to open the location feature and allow permissions.

Device cannot connect

- (1) Check whether the lamp is normally powered;
- (2) Whether the cell phone Bluetooth is open;
- (3) Whether there are other cell phones have been connected, if connected, please disconnect. Bluetooth 4.0 only supports one-to-many, does not support multi-to-many control;
- (4) Whether the Bluetooth device is connected at the phone settings, if connected, please disconnect, APP background exit and reopen, APP automatically go to connect;
- (5) Normal operation or can not be connected, please quit the APP background reopen;
- (6) The APP background exit, the phone reboot, lighting recharge; reopen APP software and then connect.

3

Operating Instructions

In the home page interface, pull down to refresh, APP automatically search for nearby devices, search for devices, click the device icon to enter the lighting control interface. Select the device, enter the lighting control interface.

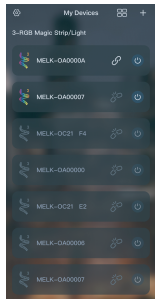

1. **Adjust:** Select the color in the color ring and adjust the brightness.

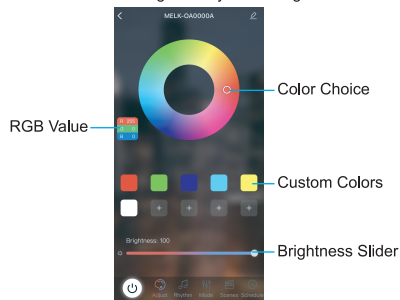

4

Operating Instructions

2. **Rhythm:** Select the song playback effect. Select between device mic and phone mic.

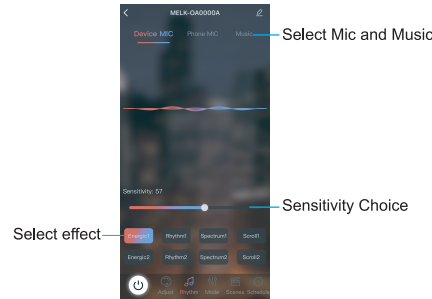

3. **Mode:** Select the mode and adjust the speed & brightness.

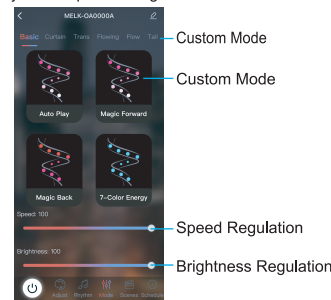

5

Operating Instructions

4. **Scenes:** Select the scenes.

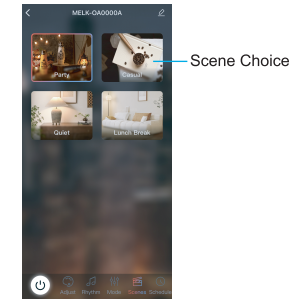

5. **Schedule:** Can be set to schedule on or off for a specified period of time

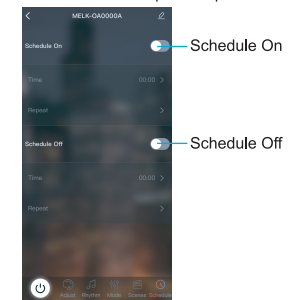

6